



we are
morfittsmith

12 Lodge Moor Road,
Sheffield,
S10 4LU



A Stunning 3-bed detached Bungalow in the sought-after Lodge Moor Road. With a drive, front and a rear gardens and scenery that is nothing short of jaw dropping, this is one not to be missed!





Why We Love It

This home is simply beautiful, and it's easy to see why anyone would fall in love with it. But for us it's the location. With stunning views and fields quite literally at your doorstep, you get a real sense of peace and tranquility.

Why You'll Love It

There is plenty of space in this attractive detached bungalow, both internally and externally. With immaculate front and rear gardens, a double drive and a large detached garage. The outside alone is nothing short of perfect, especially during the warmer seasons! With beautiful views over the vast surrounding fields, this will be the ideal spot for unwinding of an evening or having family get-togethers. You enter this home via a front porch, which is nestled in between two gorgeous bay windows, giving this bungalow its attractive and unique appearance. The entrance hall is nice and wide, immediately giving you an open and airy feeling. There is a dining room to the left where you can also access the kitchen. To the right is the lounge, which is afforded plenty of natural light, just like the dining room, thanks to the large bay windows. We have a handy washroom, a utility room and a good sized walk-in 3-piece shower room to the rear left of the property. Completing the floor plan is the 3 bedrooms. All of which are a great size, with enough space for a double bed. The layout and space of this bungalow means that each room is adaptable to meet your family needs. As peaceful as this location is, you're not too far from some of Sheffield's favourite spots, with only a short drive away from Hillsborough, Crookes and Ecclesall Road, you really do get the best of both worlds with this lovely property.







GROUND FLOOR
1789 sq.ft. (166.2 sq.m.) approx.

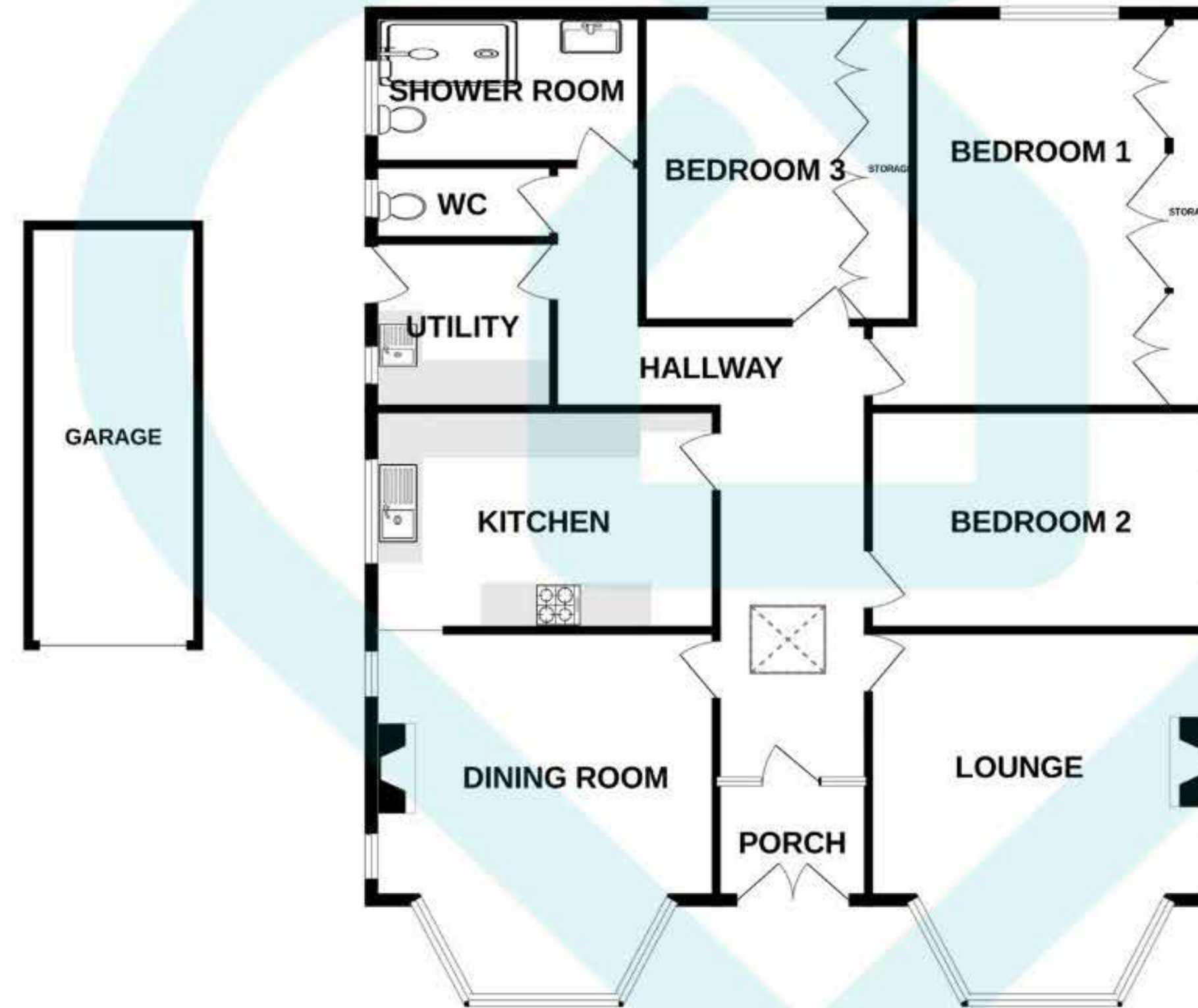

THREE BED BUNGALOW

TOTAL FLOOR AREA : 1789 sq.ft. (166.2 sq.m.) approx.

This floor plan is for illustrative purposes only. All measurements and layouts are approximations and do not necessarily capture the precise specifications of the property. No responsibility is taken for any error, omission, or misstatement. We always recommend viewing in person to confirm the exact floor plan of a property. Made with Metropix.





The MorfittSmith Building,
67 Middlewood Road,
Sheffield, S6 4GX



0114232 1764



www.morfittsmith.co.uk



sales@morfittsmith.co.uk



lettings@morfittsmith.co.uk



newhomes@morfittsmith.co.uk



@morfittsmith



@morfittsmith



MorfittSmithEstate&LettingAgent



morfittsmith



sales | lettings | new homes
